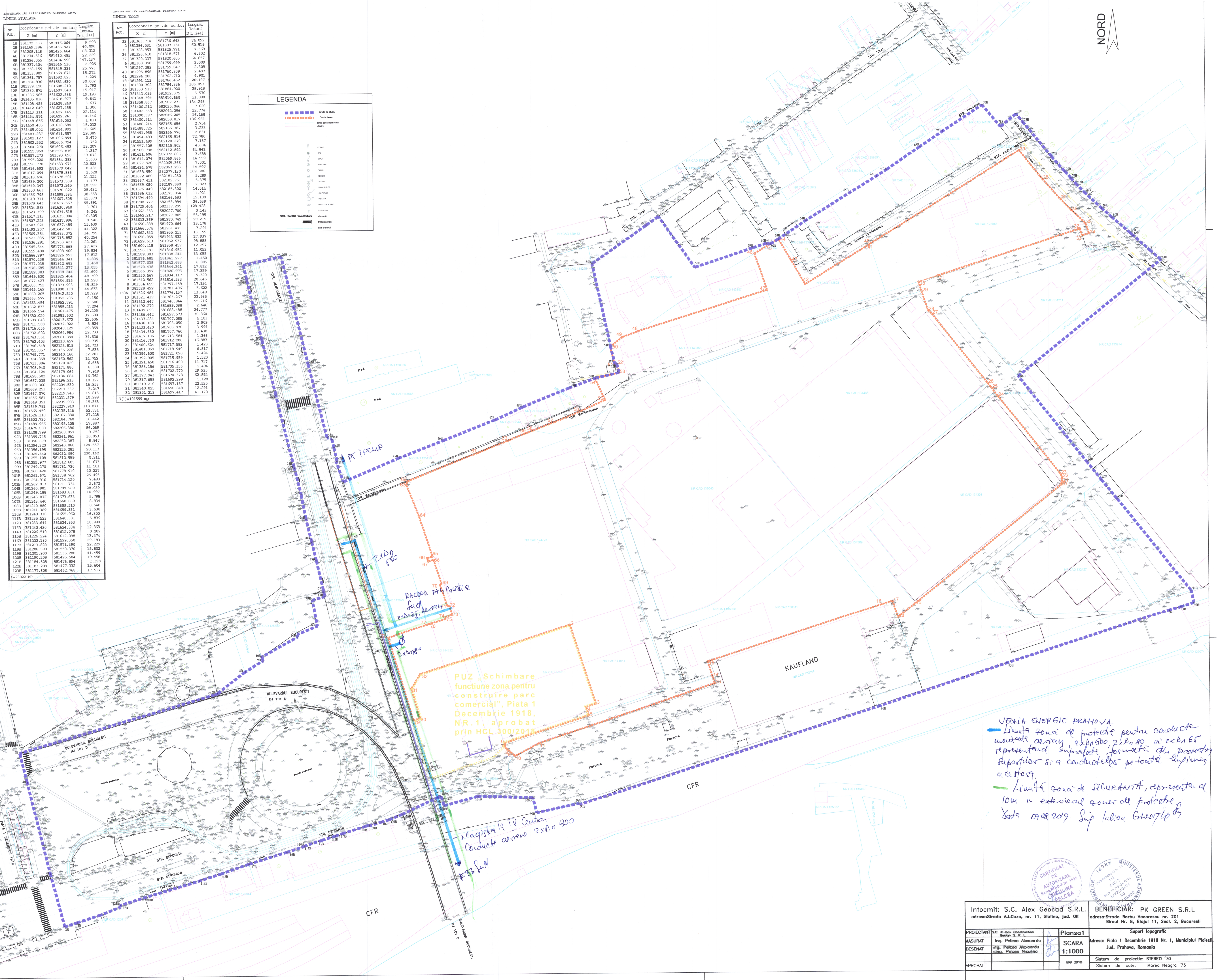
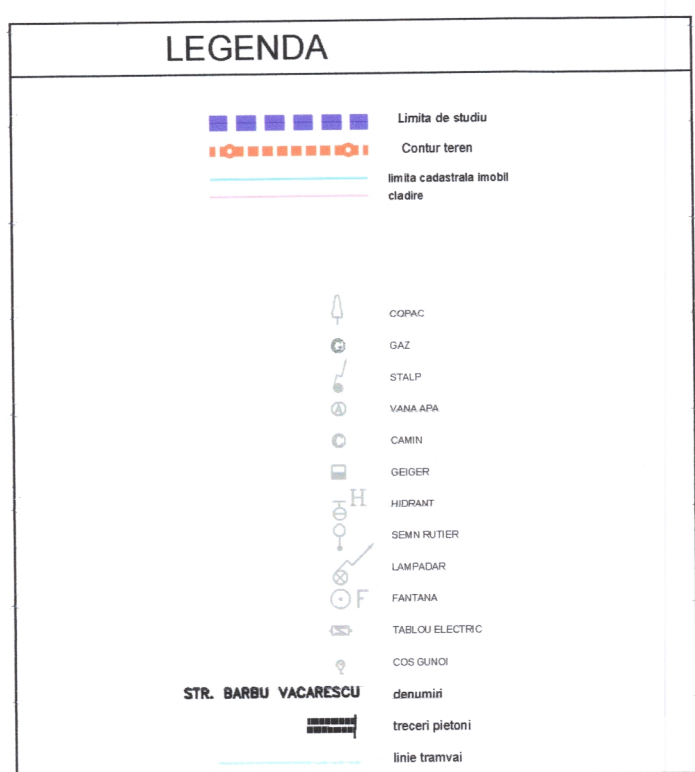

INVENTAR DE DOCUMENTOS DIEREN 1970

| Nr. | Coordonate X [m] | Coordonate Y [m] | Latitudine latitud. |
|-----|---------------------|---------------------|------------------------|
| 33 | 181363.74 | 181776.64 | 74.092 |
| 32 | 181366.51 | 181769.134 | 60.519 |
| 31 | 181326.95 | 181825.721 | 70.5 |
| 30 | 181326.95 | 181825.721 | 71.602 |
| 27 | 181320.37 | 181820.605 | 66.657 |
| 26 | 181320.37 | 181820.605 | 67.602 |
| 25 | 181297.389 | 181759.407 | 2.309 |
| 24 | 181295.896 | 181759.407 | 2.497 |
| 23 | 181291.132 | 181766.452 | 20.107 |
| 22 | 181291.132 | 181766.452 | 21.107 |
| 21 | 181333.919 | 181804.920 | 26.948 |
| 20 | 181343.495 | 181812.975 | 57.5 |
| 19 | 181343.495 | 181812.975 | 58.578 |
| 18 | 181358.867 | 181801.271 | 134.298 |
| 17 | 181358.867 | 181801.271 | 135.298 |
| 16 | 181402.558 | 182042.296 | 12.774 |
| 15 | 181390.397 | 182046.295 | 12.774 |
| 14 | 181390.397 | 182046.295 | 136.964 |
| 13 | 181486.214 | 182165.635 | 2.754 |
| 12 | 181486.214 | 182165.635 | 2.754 |
| 11 | 181491.958 | 182166.776 | 2.814 |
| 10 | 181491.958 | 182166.776 | 2.814 |
| 9 | 181557.128 | 182155.802 | 6.04 |
| 8 | 181557.128 | 182155.802 | 6.04 |
| 7 | 181611.606 | 182072.606 | 3.688 |
| 6 | 181611.606 | 182072.606 | 3.688 |
| 5 | 181627.920 | 182065.365 | 7.001 |
| 4 | 181627.920 | 182065.365 | 7.001 |
| 3 | 181672.478 | 182063.203 | 14.597 |
| 2 | 181672.478 | 182063.203 | 14.597 |
| 1 | 181672.478 | 182063.203 | 14.597 |
| 34 | 181659.050 | 182187.800 | 7.827 |
| 35 | 181676.440 | 182185.300 | 10.404 |
| 36 | 181676.440 | 182185.300 | 10.404 |
| 37 | 181679.404 | 182166.633 | 10.108 |
| 38 | 181679.404 | 182166.633 | 10.108 |
| 39 | 181729.404 | 182137.295 | 128.428 |
| 40 | 181662.352 | 182097.760 | 0.243 |
| 41 | 181662.352 | 182097.760 | 0.243 |
| 42 | 181663.359 | 182080.745 | 0.135 |
| 43 | 181663.359 | 182080.745 | 0.135 |
| 44 | 181666.574 | 182166.475 | 7.294 |
| 45 | 181662.633 | 182155.213 | 3.345 |
| 46 | 181662.633 | 182155.213 | 3.345 |
| 47 | 181629.613 | 182155.952 | 97.888 |
| 48 | 181629.613 | 182155.952 | 97.888 |
| 49 | 181596.911 | 181846.952 | 11.053 |
| 50 | 181596.911 | 181846.952 | 11.053 |
| 51 | 181597.916 | 181841.277 | 1.405 |
| 52 | 181597.916 | 181841.277 | 1.405 |
| 53 | 181566.397 | 182166.993 | 17.359 |
| 54 | 181566.397 | 182166.993 | 17.359 |
| 55 | 181562.397 | 182166.993 | 17.359 |
| 56 | 181562.397 | 182166.993 | 17.359 |
| 57 | 181562.397 | 182166.993 | 17.359 |
| 58 | 181562.397 | 182166.993 | 17.359 |
| 59 | 181562.397 | 182166.993 | 17.359 |
| 60 | 181562.397 | 182166.993 | 17.359 |
| 61 | 181562.397 | 182166.993 | 17.359 |
| 62 | 181562.397 | 182166.993 | 17.359 |
| 63 | 181562.397 | 182166.993 | 17.359 |
| 64 | 181562.397 | 182166.993 | 17.359 |
| 65 | 181562.397 | 182166.993 | 17.359 |
| 66 | 181562.397 | 182166.993 | 17.359 |
| 67 | 181562.397 | 182166.993 | 17.359 |
| 68 | 181562.397 | 182166.993 | 17.359 |
| 69 | 181562.397 | 182166.993 | 17.359 |
| 70 | 181562.397 | 182166.993 | 17.359 |
| 71 | 181562.397 | 182166.993 | 17.359 |
| 72 | 181562.397 | 182166.993 | 17.359 |
| 73 | 181562.397 | 182166.993 | 17.359 |
| 74 | 181562.397 | 182166.993 | 17.359 |
| 75 | 181562.397 | 182166.993 | 17.359 |
| 76 | 181562.397 | 182166.993 | 17.359 |
| 77 | 181562.397 | 182166.993 | 17.359 |
| 78 | 181562.397 | 182166.993 | 17.359 |
| 79 | 181562.397 | 182166.993 | 17 |

[illegible]

VEHICLA ENERGIIE PRATOVA

- Limita zonă de protecție pentru conducte medii aerian $2 \times 1,80, 2 \times 1,80$ și exan 6r reprezentând suprafațe formate din proiectii superioare și a conductelor pe toate liniile a cefosq.
- Limita zonă de siguranță, reprezentan d 10m n extensia zonă de protecție

Sats 09.09.2019 Sup laboru Gheorghe B

| | | | |
|--|--|---|---|
| Intocmit: S.C. Alex Geocard S.R.L. adresa:Srăda Al.Cuza, nr. 11, Slafoia, jud. OH | | BENEFICIAR: PK GREEN S.R.L adresa:Strada Barbu Văceasru nr. 201 Brăul Nr.8, Etajul 11, Sect. 2, București | |
| PROIECTANT: <u>S.C. K-Base Construction</u> Ing. <u>Pelica Alexandru</u> | | Plansa 1 | Support topografic |
| MĂSURAT Ing. <u>Pelica Alexandru</u> | | SCARA | Adresa: Piața 1 Decembrie 1918 nr. 1, Municipiul Ploiești |
| DENESAT Ing. <u>Pelica Alexandru</u> sing. <u>Pelica Niculina</u> | | 1:1000 | Jud. Prahova, Romania |
| APROBAT | | NN 2018 | Sistem de proiecte: STEREO "70" Sistem de cote: Marela Neagra "75" |